

**YACHATS
RIVER BASIN**

**MASTER PLAN
FOR ANGLER ACCESS AND
ASSOCIATED RECREATIONAL
USES**

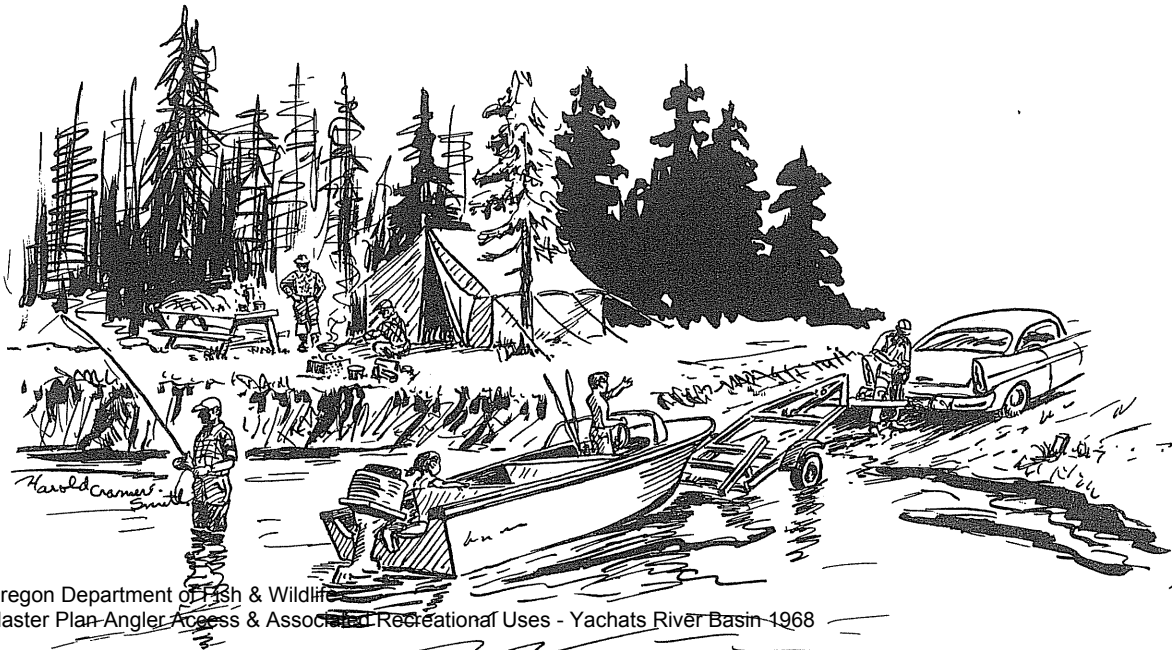

**Oregon State Game Commission
Lands Division**



YACHATS RIVER BASIN
Master Plan for Angler Access
and
Associated Recreational Uses

By

Oregon State Game Commission

Lands Section

July 1968

T A B L E O F C O N T E N T S

THE PLAN 1
VICINITY MAP 3
AREA I 5
AREA II 19
APPENDIX - Yachats River Basin map

YACHATS RIVER BASIN
Master Plan for Angler Access
and
Associated Recreational Uses

The Yachats River is a short coastal stream which flows in a westerly direction from Yachats Mountain to Pacific Ocean at Yachats. The basin covers approximately 61 square miles and the river is 17 miles in length. The stream gradient is generally moderate and the water quality is good. The flows fluctuate seasonally with the highest runoff occurring from November through April.

The Yachats River has excellent runs of coho salmon, winter steelhead and cutthroat trout. Angling pressure ranges from light to moderate due principally to its distance from population centers and to the popularity of the larger Alsea and Siuslaw Rivers which are only a short distance from the basin.

Most of the Yachats River is accessible from public roads but extensive private ownership of frontage requires the angling public to rely mainly on access over private lands. These lands are currently used for the production of dairy, beef and sheep products and public use has created only minor problems. The present trends, however, indicate that private developments will soon spread into this area from the coastline and the access problems will increase accordingly.

This report details a plan that we hope can be followed to solve the access problems of the Yachats River Basin. Too, we hope that all agencies that are interested in retaining existing water access as well as providing additional facilities, whether they be municipal, county or state, will all

join in a cooperative effort to carry out this plan in an orderly manner. It is probable that Land and Water Conservation Funds will be available on a 50-50 matching basis. In order to acquire these funds, it will be necessary to apply through the Oregon State Highway Department.

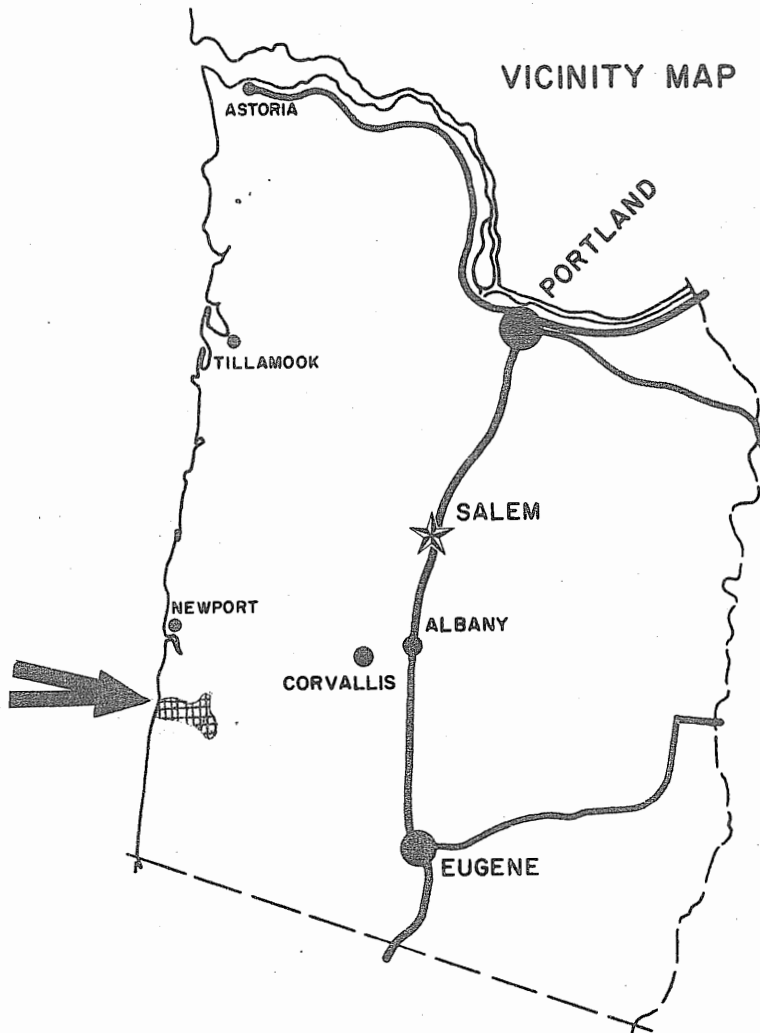

The Yachats River Basin is located in the central portion of western Oregon between the Pacific Ocean and the summit of the Coast Range.

The major access route through the basin is County Road 804 which joins U. S. Route 101 at the town of Yachats. The basin lies approximately 138 miles southwest of Portland.

AREA I

Area I includes the main Yachats River upstream to the North Fork, a distance of 8.5 river miles. It includes the tidewater zone and encompasses the section of river that is open to winter fishing under present regulations.

This section of the river has excellent runs of winter steelhead, coho salmon and cutthroat trout. Angling pressure ranges from light to moderate due to its distance from population centers. There is a drift boat and bank fishery along most of this section. At present nearly all access points are on private property and are subject to closure. A total of six sites would provide adequate access in this area and insure future use.

The following evaluation sheets indicate the various access sites needed. The sites selected have been chosen on the basis of angler preference and success.

WATER ACCESS SITE EVALUATION

Yachats River System Site No. 1
I Area Priority A
Name Yachats Landing

Location 0.8 miles above the town or Yachats, North Bank
T14 S, R 11, Sec. 26 River Mile 1.25 County Lincoln
Ownership: Public _____
Private X Tax Lot No. 300
Number of owners 1

DESCRIPTION

Land type Mountainous
Cover type Mixed coniferous and deciduous trees
Road access County road No. 804, Condition Paved
Flows Fluctuate seasonally Water quality Good-Tidal area
Present stage of development Complete (Gravel ramp)

ANGLER NEEDS

Acquisition: 0.25 Acres, 300 feet of frontage
Type of conveyance Purchase or perpetual easement

Development:

Boat ramp: Type _____ Number of lanes _____
Toilets X Trails _____ Roads _____
Parking area X; For _____ cars or 10 car-trailer units

This site provides a launching ramp for drift boats.

AREA I

SITE # 1

FISHERY: The fishery consists primarily of sea-run cutthroat, however,
 some coho salmon and steelhead are taken.

	Spring	Summer	Fall	Winter
Heavy				
Medium	Tr	Tr	Tr	
Light			Sa, St	Sa, St

(Sa - Salmon, St - Steelhead, Tr - Trout, Sg - Sturgeon, Ww - Warm Water Fishes)

SKETCH

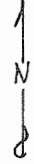

Seasons (Check)

	Spring	Summer	Fall	Winter
Boating, motor	X	X	X	X
Boating, non-motor	X	X	X	X
Camping, tent				
Camping, trailer				
Fishing, boat		X	X	X
Fishing, shore		X	X	X
Hiking				
Horseback riding				
Hunting, big game				
Hunting, upland game				
Hunting, waterfowl				
Nature study				
Picnicking				
Sightseeing				
Skin and scuba diving				
Swimming				
Water skiing				

RECREATION
(Check)

- Boating, motor
- Boating, non-motor
- Camping, tent
- Camping, trailer
- Fishing, boat
- Fishing, shore
- Hiking
- Horseback riding
- Hunting, big game
- Hunting, upland game
- Hunting, waterfowl
- Nature study
- Picnicking
- Sightseeing
- Skin and scuba diving
- Swimming
- Water skiing

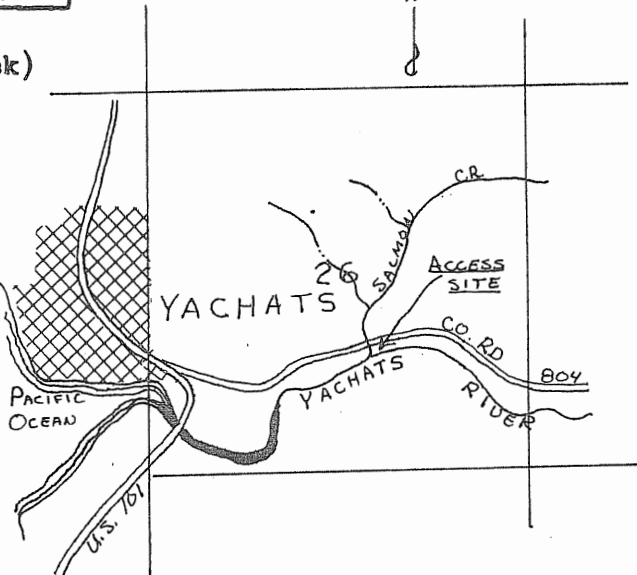

OTHER

Safety Problems: Close proximity of the highway

Group Facilities:

REMARKS

This site is currently being used as a launching and takeout site by anglers.

The parking area is limited to the shoulder of the road.

WATER ACCESS SITE EVALUATION

Yachats River System Site No. 2
I Area Priority B
Name Gravel Pit Site

Location Approximately 1.5 mile from Yachats, North Bank
T 14, R 12 W, Sec. 25 River Mile 1.75 County Lincoln
Ownership: Public U. S. Government
Private _____ Tax Lot No. 500
Number of owners _____

DESCRIPTION

Land type Mountainous
Cover type Both deciduous and coniferous trees and shrubs
Road access County road No. 804, Condition Paved
Flows Fluctuate seasonally Water quality Good
Present stage of development The area has been leveled for gravel storage.

ANGLER NEEDS

Acquisition: 0.75 Acres, 300 feet of frontage
Type of conveyance _____

Development:

Boat ramp: Type Gravel ramp Number of lanes _____
Toilets X Trails _____ Roads _____
Parking area _____; For _____ cars or _____ car-trailer units

This site provides access to the river as well as an area for parking.

AREA I

SITE # 2

FISHERY: There are fisheries on both winter steelhead and cutthroat trout as well as a light fishery on coho salmon.

	Spring	Summer	Fall	Winter
Heavy				
Medium	Tr	Tr	Tr	St
Light			Sa, St	

(Sa - Salmon, St - Steelhead, Tr - Trout, Sg - Sturgeon, Ww - Warm Water Fishes)

SKETCH

Seasons (Check)

RECREATION
(Check)

- Boating, motor
- Boating, non-motor
- Camping, tent
- Camping, trailer
- Fishing, boat
- Fishing, shore
- Hiking
- Horseback riding
- Hunting, big game
- Hunting, upland game
- Hunting, waterfowl
- Nature study
- Picnicking
- Sightseeing
- Skin and scuba diving
- Swimming
- Water skiing

	Spring	Summer	Fall	Winter
	X		X	X
		X	X	X
	X	X	X	

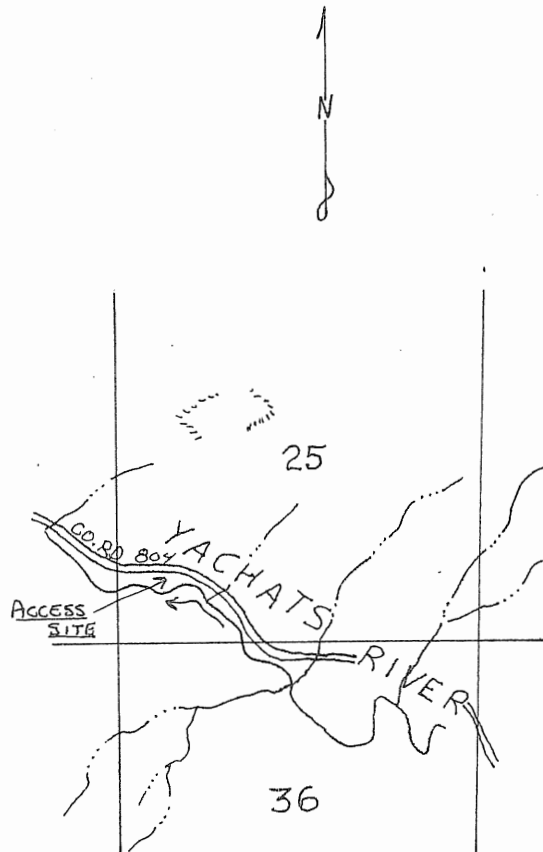

OTHER

Safety Problems:

Group Facilities:

REMARKS

This is a site, located at the head of tidewater, which has been used by the U. S. Government for gravel storage. The site is level and provides a good parking area along the river. Bank access could be improved with some brush clearing. A gravel ramp would be desirable at this location for taking out drift boats. This site is located at the head of tidewater.

WATER ACCESS SITE EVALUATION

Yachats System Site No. 3
I Area Priority B
Name Yachats Valley Area

Location Between Marks and Helms Creeks, North Bank
T 14 S, R 11 W, Sec. 31,32,33,34 River Mile 4-7.5 County Lincoln

Ownership: Public
Private X Tax Lot No. Many
Number of owners Many

DESCRIPTION

Land type Narrow valley
Cover type Pasture and cropland with deciduous and coniferous trees
Road access County road No. 804, Condition Good
Flows Fluctuate seasonally Water quality Good
Present stage of development None

ANGLER NEEDS

Acquisition: _____ Acres, 1.5 miles of frontage
Type of conveyance Purchase or easements

Development:

Boat ramp: Type _____ Number of lanes _____
Toilets _____ Trails X Roads _____
Parking area _____; For _____ cars or _____ car-trailer units

This site would provide bank access to approximately 1.5 miles of the
river.

WATER ACCESS SITE EVALUATION

Yachats River System Site No. 4
I Area Priority B
Name Reedy Creek site

Location Mouth of Reedy Creek, South Bank
T 14 S, R 11 W, Sec. 31 River Mile 3.5 County Lincoln
Ownership: Public U. S. Government
Private X Tax Lot No. 2500
Number of owners _____

DESCRIPTION

Land type Mountainous with level area adjacent to the river
Cover type Both deciduous and coniferous trees
Road access Private, Condition Good
Flows Fluctuate seasonally Water quality Good
Present stage of development None

ANGLER NEEDS

Acquisition: One Acres, _____ of frontage
Type of conveyance Purchase or perpetual easement

Development:

Boat ramp: Type Gravel Number of lanes 1
Toilets X Trails _____ Roads X
Parking area X; For _____ cars or 60 car-trailer units

This site would provide boat and shoreline access.

AREA I

SITE # 4

FISHERY: Winter steelhead, cutthroat trout and coho salmon are available
in the portion of the stream.

	Spring	Summer	Fall	Winter
Heavy				
Medium	Tr	Tr	Tr	St
Light			Sa, St	

(Sa - Salmon, St - Steelhead, Tr - Trout, Sg - Sturgeon, Ww - Warm Water Fishes)

SKETCH



Seasons (Check)

RECREATION
(Check)

- Boating, motor
- Boating, non-motor
- Camping, tent
- Camping, trailer
- Fishing, boat
- Fishing, shore
- Hiking
- Horseback riding
- Hunting, big game
- Hunting, upland game
- Hunting, waterfowl
- Nature study
- Picnicking
- Sightseeing
- Skin and scuba diving
- Swimming
- Water skiing

	Spring	Summer	Fall	Winter
	X	X	X	X
		X	X	X
		X	X	X
	X	X	X	

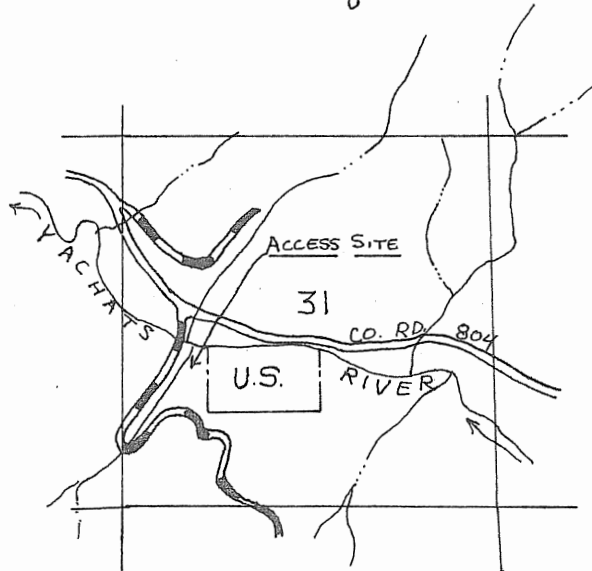

OTHER

Safety Problems:

Group Facilities:

REMARKS

This site includes a parcel of private land and a parcel of U. S. Forest Service land. There is an excellent boat ramp site on the private holdings and the Forest Service land would provide an ideal camp-picnic area. Both parcels have good bank access.

WATER ACCESS SITE EVALUATION

Yachats River System Site No. 5
I Area Priority A
Name Tripp Site

Location Downstream from Carson Creek 5.25- North Bank
T 14 S, R 11 W, Sec. 32 River Mile 5.75 County Lincoln
Ownership: Public _____
Private X Tax Lot No. 1100
Number of owners _____

DESCRIPTION

Land type Mountainous
Cover type Coniferous tree overstory, deciduous shrub understory
Road access County Road No. 804, Condition Gravel - Good
Flows Fluctuate seasonally Water quality Good
Present stage of development Roadway used for drift boat launching

ANGLER NEEDS

Acquisition: 8.5 Acres, 2800 feet of frontage
Type of conveyance Purchase or perpetual easement

Development:

Boat ramp: Type Gravel Number of lanes 1
Toilets X Trails X Roads X
Parking area X; For 50 cars or 25 car-trailer units

This site would provide access to the Yachats River as well as launching
and picnic facilities.

AREA I

SITE # 5

FISHERY: The fishery is on winter steelhead and cutthroat trout. There is
light fishery on coho salmon in the fall.

	Spring	Summer	Fall	Winter
Heavy				
Medium	Tr	Tr	Tr	St
Light			Sa, St	

(Sa - Salmon, St - Steelhead, Tr - Trout, Sg - Sturgeon, Ww - Warm Water Fishes)

SKETCH

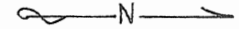

Seasons (Check)

	Spring	Summer	Fall	Winter
Boating, motor				
Boating, non-motor	X		X	X
Camping, tent	X	X	X	
Camping, trailer	X	X	X	
Fishing, boat		X	X	X
Fishing, shore		X	X	X
Hiking				
Horseback riding				
Hunting, big game				
Hunting, upland game				
Hunting, waterfowl				
Nature study				
Picnicking	X	X	X	
Sightseeing	X	X	X	X
Skin and scuba diving				
Swimming				
Water skiing				

RECREATION
(Check)

- Boating, motor
- Boating, non-motor
- Camping, tent
- Camping, trailer
- Fishing, boat
- Fishing, shore
- Hiking
- Horseback riding
- Hunting, big game
- Hunting, upland game
- Hunting, waterfowl
- Nature study
- Picnicking
- Sightseeing
- Skin and scuba diving
- Swimming
- Water skiing

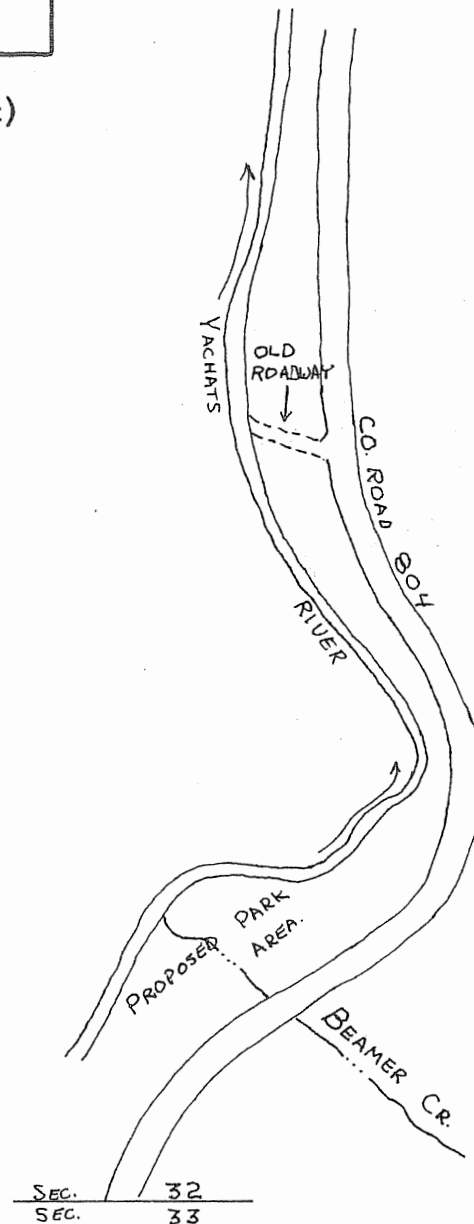

OTHER

Safety Problems:

Group Facilities:

REMARKS

This parcel of land lies between the Yachats River and county road. Good access makes this site very desirable as a recreational area. The old roadway on the lower portion of the property could be developed for boat launching quite easily.

WATER ACCESS SITE EVALUATION

Yachats River System Site No. 6
I Area Priority C
Name Carson Site

Location Near the mouth of Bend Creek, North Bank
T 15S, R 11 W, Sec. 33 River Mile 7.0 County Lincoln

Ownership: Public _____
Private X Tax Lot No. 1400
Number of owners _____

DESCRIPTION

Land type Narrow valley
Cover type Both deciduous and coniferous trees and shrubs
Road access County road No. 804, Condition Good
Flows Fluctuate seasonally Water quality Good
Present stage of development None

ANGLER NEEDS

Acquisition: _____ Acres, 0.25 miles of frontage
Type of conveyance Purchase of easement

Development:

Boat ramp: Type Pole ramp Number of lanes 1
Toilets X Trails _____ Roads _____
Parking area X; For 10 cars or 5 car-trailer units

This site would provide bank access to 0.25 miles of river frontage.

AREA II

Area II includes the headwaters of the stream from river mile 8.5 through 17 and the North Fork.

This portion of the basin has been closed to winter angling in an effort to protect the spawning stocks of salmon and steelhead. Both the North Fork and the upper main stem are relatively small streams and are the major spawning and rearing areas in the basin. The legal-size trout population is small and does not support an extensive summer fishery.

Since the basin is small and is managed primarily for the anadromous species it is felt that no additional angler access is needed. The majority of the property in this area is in private ownership; however, access is available and adequately meets the present fishery demands.